

	VESTEL LARDER	CUSTOMER SUPPORT
	ASSEMBLE & DISASSEMBLE	

A- Changing The Door Swing Direction to Right Hand

1- Lie down the appliance to the left side. (FIG-1)

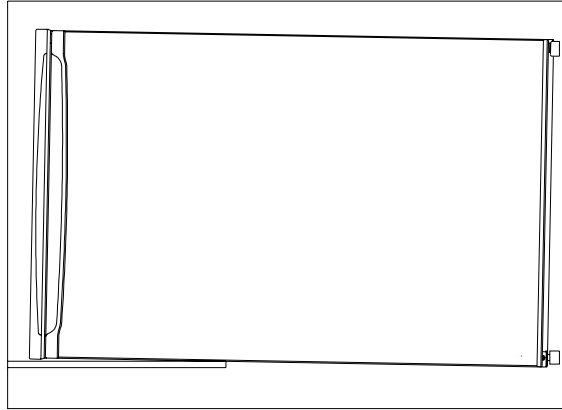

Figure - 1

2- Dismantle both leveling foot. (FIG-2)

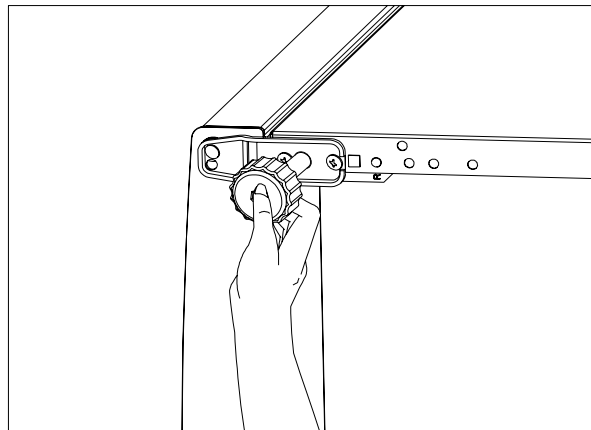

Figure - 2

3- Unscrew the bottom hinge fixing screws and remove it. (FIG-3.1)

Unscrew the bottom hinge pin and screw in the next hole. (FIG-3.2)

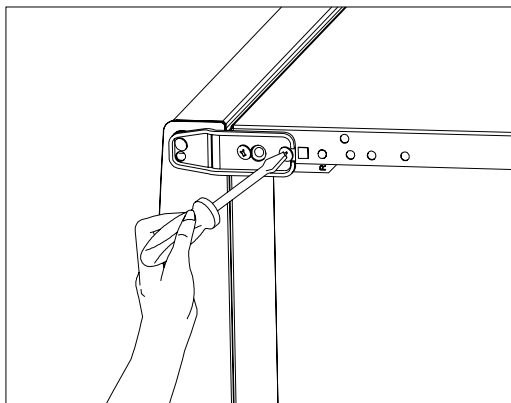

Figure - 3.1

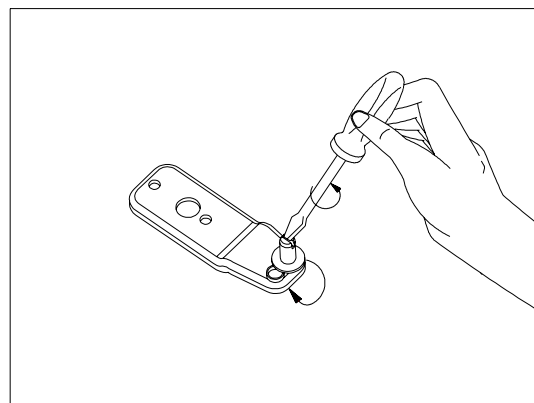

Figure - 3.2

	VESTEL LARDER	CUSTOMER SUPPORT
	ASSEMBLE & DISASSAMBLE	

4- Remove the door. (FIG-4)

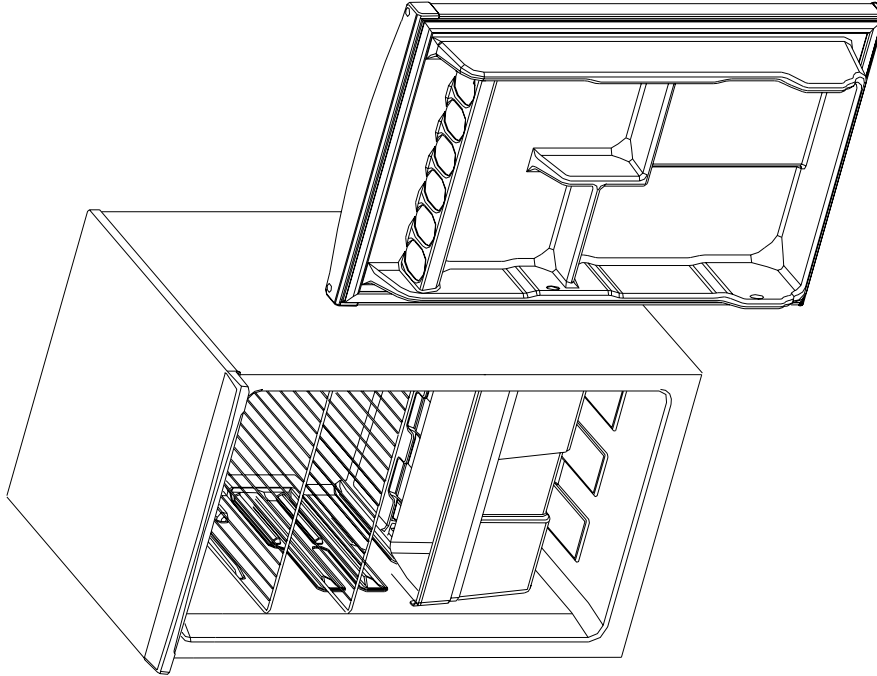

Figure - 4

5- Unscrew the right pin of the top hinge. (FIG-5)

6- Screw the pin on the left hole of the top hinge. (FIG-6)

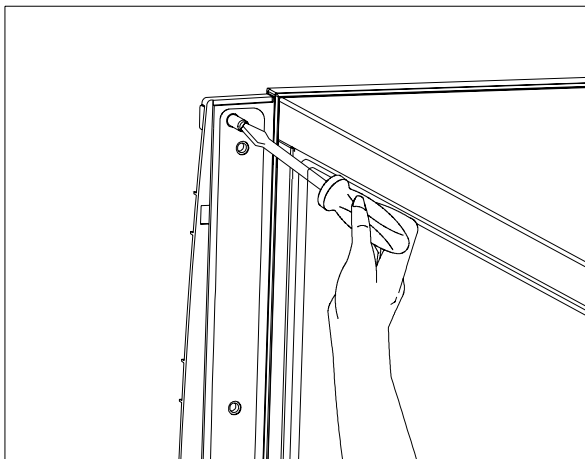

Figure - 5

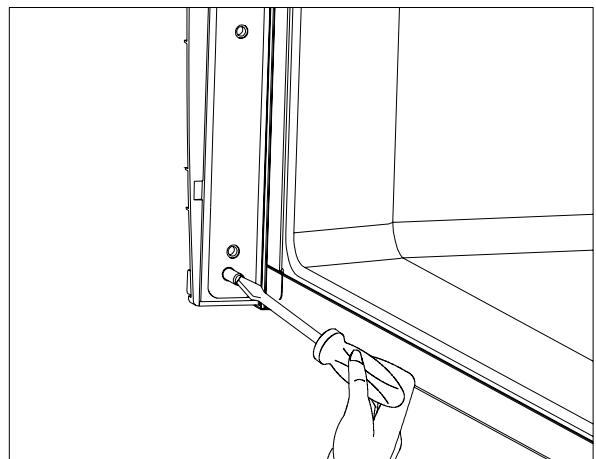

Figure - 6

	VESTEL LARDER	CUSTOMER SUPPORT
	ASSEMBLE & DISASSAMBLE	

7- Replace the top bushing and top bushing cap. (FIG-7)

Remove the bottom bushing and bottom stopper and assemble them to the left side.

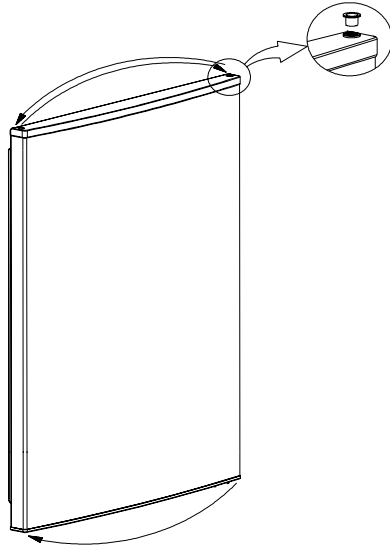

Figure - 7

8- Assemble the door to the top hinge. (Reverse operation of item 4)

9- Screw the bottom hinge to the left side of the refrigerator and screw the both leveling feet.

	VESTEL LARDER	CUSTOMER SUPPORT
	ASSEMBLE & DISASSAMBLE	

B - Changing The Thermostat :

- 1) Remove the lamp cover and unscrew the fixing screw.
- 2) Remove the screw cap and unscrew the fixing screw.
- 3) Remove the thermostat box by pulling it and disconnecting the wire connector.
- 4) Remove the thermostat knob by pulling forward. Loosen the nut fixing the thermostat.
- 5) Pull out the thermostat bulb from the housing.
- 6) Replace the thermostat with a new one and assemble the thermostat box following the steps backwards.

C - Thermostat Knob

- ❖ This knob is used to control the temperature of the freezer and refrigerator parts automatically. It can be set to any value between “0” and “5” positions.
- ❖ “0” position indicates that the thermostat is “off”. The refrigerator is “off” on this setting.
- ❖ By turning the knob between “1” and “5”, you can increase or decrease the cooling degree.
- ❖ The refrigerator is designed to get optimum performance when the thermostat knob is set between position “2” to “4”.

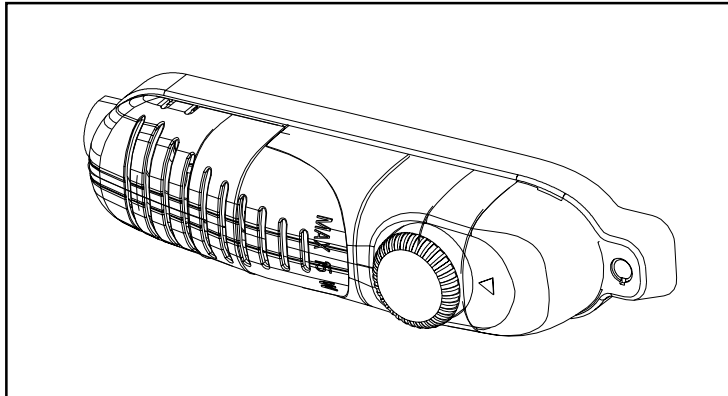



VESTEL LARDER

CUSTOMER
SUPPORT

REFRIGERANT CYCLE DIAGRAM

