

	VESTEL FREEZER	CUSTOMER SUPPORT
	ASSEMBLE & DISASSEMBLE	

A- Changing The Door Swing Direction to Right Hand

1- Lie down the appliance to the left side. (FIG-1)

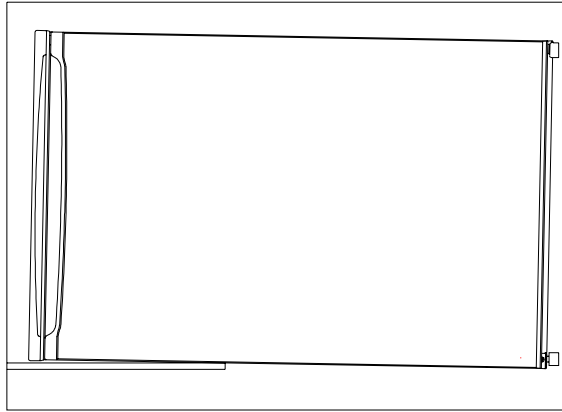

Figure - 1

2- Dismantle both leveling foot. (FIG-2.1)

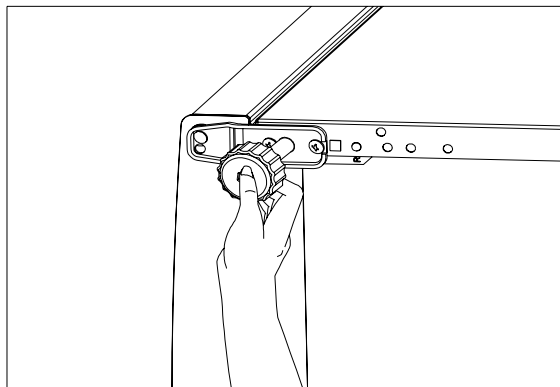

Figure - 2

3- Unscrew the bottom hinge fixing screws and remove it. (FIG-3.1)

Unscrew the bottom hinge pin and screw in the next hole. (FIG-3.2)

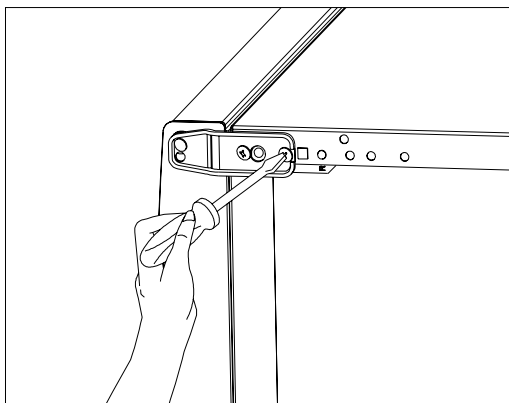

Figure - 3.1

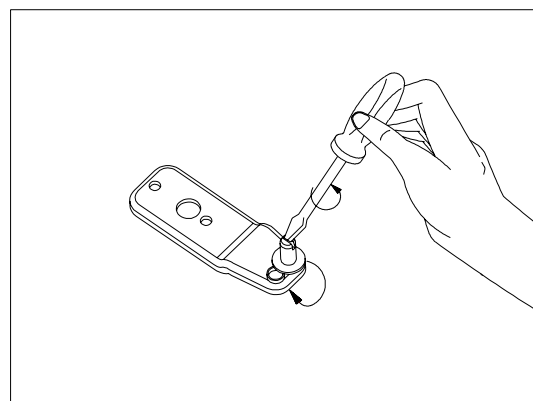

Figure - 3.2

	VESTEL FREEZER	CUSTOMER SUPPORT

4- Remove the door. (FIG-4)

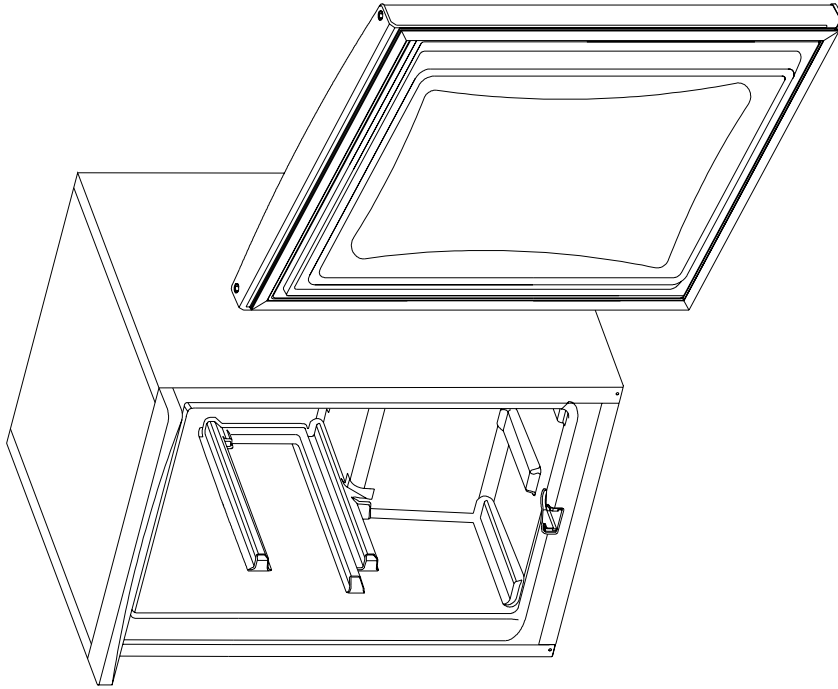

Figure - 4

5 - Unscrew the pin of the right top hinge (FIG-5/Detail-B) and screw it to the left hinge (FIG-5/Detail-A)

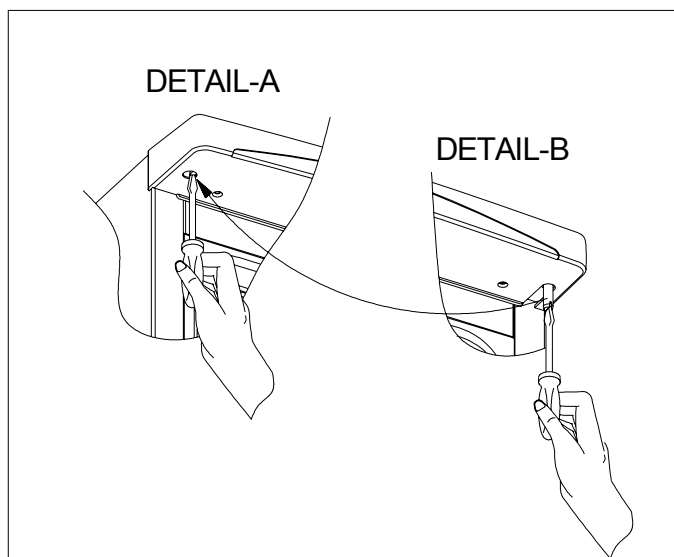

Figure - 5

	VESTEL FREEZER	CUSTOMER SUPPORT
	ASSEMBLE & DISASSAMBLE	

6- Replace the top bushing and top bushing cap. (FIG-6)

Remove the bottom bushing and bottom stopper and assemble it to the left side. (FIG-6)

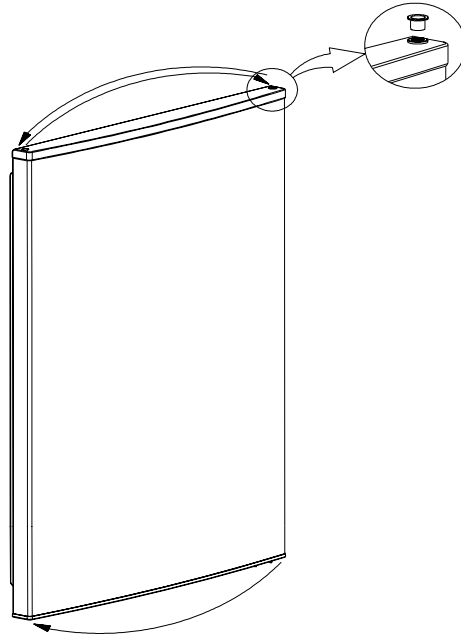

Figure - 6

7- Assemble the door to the top hinge. (Reverse operation of item 4)

8- Screw the bottom hinge to the left side of the refrigerator and screw the both leveling feet.

B - Thermostat Knob

- ❖ This knob is used to control the temperature of the freezer and refrigerator automatically. It can be set to any value between the "0" and "3" positions.
- ❖ "0" position indicates that the thermostat is "off" The refrigerator is "off" in this setting.
- ❖ By turning the knob from "1" to "3" positions , you can increase the cooling degree.
- ❖ The refrigerator is designed to get optimum performance when the thermostat knob is set in the middle position.

