

	<b>VESTEL BUILT-IN COMBI</b>	<b>CUSTOMER SUPPORT</b>
	<b>ASSEMBLE &amp; DISASSEMBLE</b>	

### Changing The Door Swing Direction to Right Hand

1- Unscrew the two screws fixing the top hinge (Fig-1) and remove the freezer door. (Fig-2)

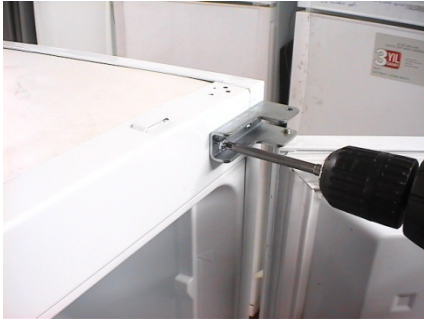

Figure 1



Figure 2

2- Unscrew the two screws fixing the middle hinge side bracket and remove it. (Fig-3)



Figure 3

3- Unscrew the two screws fixing the middle hinge (Fig-4) and remove the refrigerator door. (Fig-5)



Figure 4



Figure 5

	<b>VESTEL BUILT-IN COMBI</b>	<b>CUSTOMER SUPPORT</b>
	<b>ASSEMBLE &amp; DISASSEMBLE</b>	

**4-** Remove the bottom hinge pin (Fig-5) and insert it to the left side foot. (Fig-6)



Figure 5



Figure 6

**5-** Unscrew the middle hinge side bracket on the left and remove it. (Fig-7)  
Remove the middle hinge screw caps (big) on the left side.



Figure 7

**6-** Assemble the refrigerator door. Rotate the middle hinge by 180° and screw it to the left side. (Fig-8) Then screw the middle hinge side bracket on the middle hinge. (Fig-9)



Figure 8



Figure 9

	<b>VESTEL BUILT-IN COMBI</b>	<b>CUSTOMER SUPPORT</b>
	<b>ASSEMBLE &amp; DISASSEMBLE</b>	

7- Remove the top hinge screw caps (big) on the left side (Fig-10) and insert them to the right side. (Fig-11) (You can find the new caps in the user manual bag)



Figure 10



Figure 11

8- Unscrew the pin of the hinge from Hole 1, rotate the top hinge by 180° and screw the pin to Hole 2. (Fig-12)

9- Assemble the freezer door and screw the top hinge to the left side. (Fig-13)

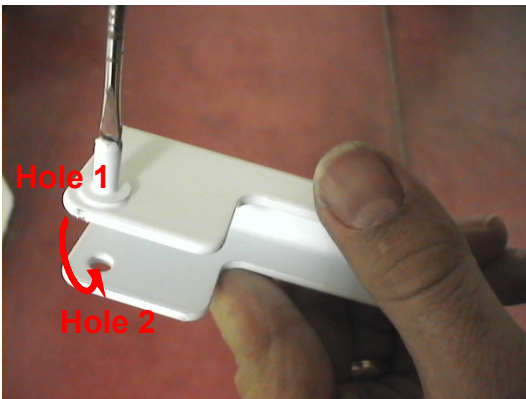

Figure 12



Figure 13

10- Screw the middle hinge side bracket on the right of refrigerator. (Fig-14) and insert the middle hinge screw caps (big) on the right side. (Fig-15) (You can find the new caps in the user manual bag)



Figure 14



Figure 15



 <b>WHITE GOODS</b>	<b>VESTEL BUILT-IN COMBI</b>	<b>CUSTOMER SUPPORT</b>
	<b>INSTRUCTIONS</b>	

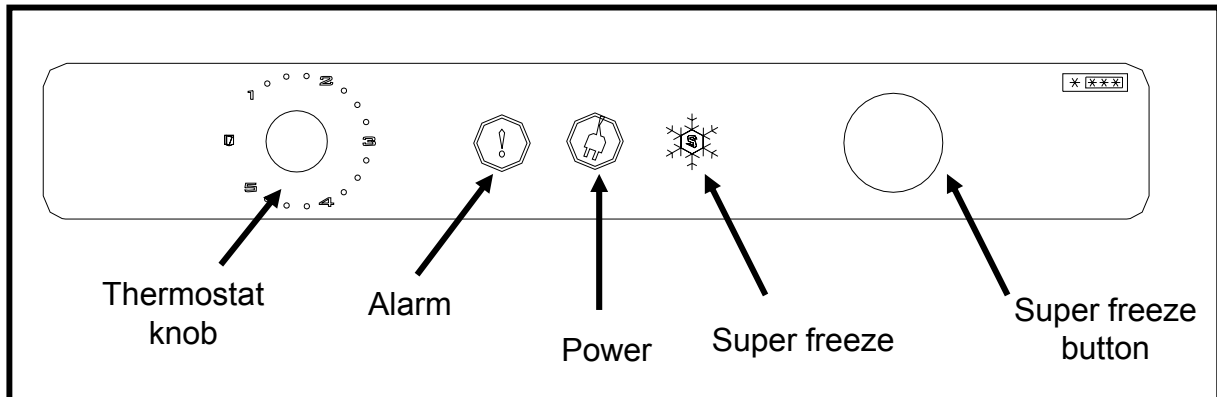

**Thermostat Setting :**

The freezer and refrigerator thermostats automatically regulates the inside temperature of the compartments. By rotating the knob from position 1 to 5, colder temperatures can be obtained. “0” position shows thermostat is closed and no cooling will be available.

**Thermostat knob position;**

**0 :** The appliance is switched off.

**1-2 :** For short-term storage of food in the freezer compartment, you can set the knob between minimum and medium position.

**3-4:** For long-term storage of food in the freezer compartment, you can set the to medium position.

**5 :** For freezing the fresh food. The appliance will run colder temperatures.

**Freezing with Super Freeze (SF button)**

Press the SF button, the freezer will start to run continuously with maximum performance (observe that the SF lamp will light on prange when you turn on the SF button) The freezer temperature will decrease and the appliance will switch to the lowest temperature. Place the food to be frozen quickly inside the freezer, preferably in the top drawers. Once the food is frozen, you must turn off the SF button and set the thermostat knob to desired position.

**Display Panel :**

**Alarm light :** Lights red, when the temperature rises to a critical point in side the freeze.

**Power light :** Light green automatically, when the appliance is connected to the power supply.

**Super freeze light (SF light) :** Lights orange, when the SF button is turned on.

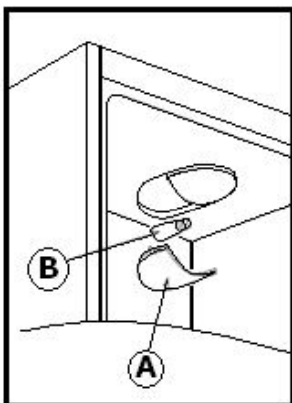

**Replacing the refrigerator lightbulb :**

- 1- Unplug the unit from the power supply.
- 2- Remove the refrigerator light cover (A) by pressing the hooks placed on both sides of the cover.
- 3- Change the light bulb (B) with a new one (not more than 15W)
- 4- Place the light cover in its place and plug the unit.

